

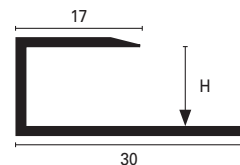

This terminal edge perimeter profile trim is especially designed for floating wooden floors to ideally finish a wall edge and adjacent floors. It also serves as an expansion joint and is an alternative to skirting. Also ideal for edging sliding doors tracks and entrance mat edging. It can be fixed with dowels or screws and guarantees a perfect hold. To be fixed with screws and dowels.

woodtec™ LT



Illustrated scale dimension 1:1

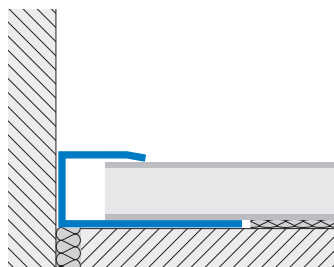

WOODTEC LT-A*N Anodised aluminium

The profile is anodised aluminium with Silver (AS), Gold (AO) or Bronze (AB) colour finish. The profile is easily adaptable to several coverings for colour and texture and is well tolerant to oxidation but less resistant to mechanical impact. In areas with higher transit the use of the solid brass article is recommended.

	H=mm	Art.		
Material:	7	LT	70	A*N
Extruded anodised aluminium	9	LT	90	A*N
Finish*: Silver (AS), Gold (AO), Bronze (AB)	10	LT	100	A*N
	13	LT	130	A*N
Length: 2,70 metres	15	LT	150	A*N

WOODTEC LT-OLN Polished Brass

Thanks to the natural properties of brass, this profile is highly tolerant to mechanical impact and areas subject to chemical presence yet still helps maintain an elegant finish to the coverings applied.

Material:	10	LT	100	OLN
Laminated Brass	15	LT	150	OLN
Finish: Polished (OLN)	22	LT	220	OLN
Length: 2,70 metres				

WOODTEC LT-ILN Polished Stainless Steel

High tolerance steel profile particularly recommended for commercial and industrial environments. This article is also recommended for heavy transit areas offering a good mechanical resistance.

Material:	10	LT	100	ILN
Stainless Steel	15	LT	150	ILN
Finish: Polished (ILN)	22	LT	220	ILN
Length: 2,70 metres				

WOODTEC LT 90*N Aluminium Wood Cladding Finish

Profile for the most common mismatching floors ranging between 7,5 and 9 mm. Melamine wood tone in 8 different varieties. Good tolerance to abrasion comparable to most melamine coverings. The melamine embossing on the aluminium is particularly smooth therefore it remains quite clean and blends well with the flooring tone.

	Finish	Art.		
Material:	Whitened	LT	90	RSN
Extruded Aluminium Laminate cov.	Maple	LT	90	ACN
	Beech	LT	90	FAN
	Oak	LT	90	RON
	Cherry	LT	90	CIN
Finish*: 8 wood finish	Light walnut	LT	90	NCN
	Dark walnut	LT	90	NSN
	Wengé	LT	90	WEN
Altezza: 9 mm				